

DEBUT



Virage
BAYSHORE

DEBUT

3 BED / DEN / 3.5 BATH

Level 4-12, 14-19:

Conditioned 3270 sq. ft.

Terraces 787 sq. ft.

Total Living 4057 sq. ft.

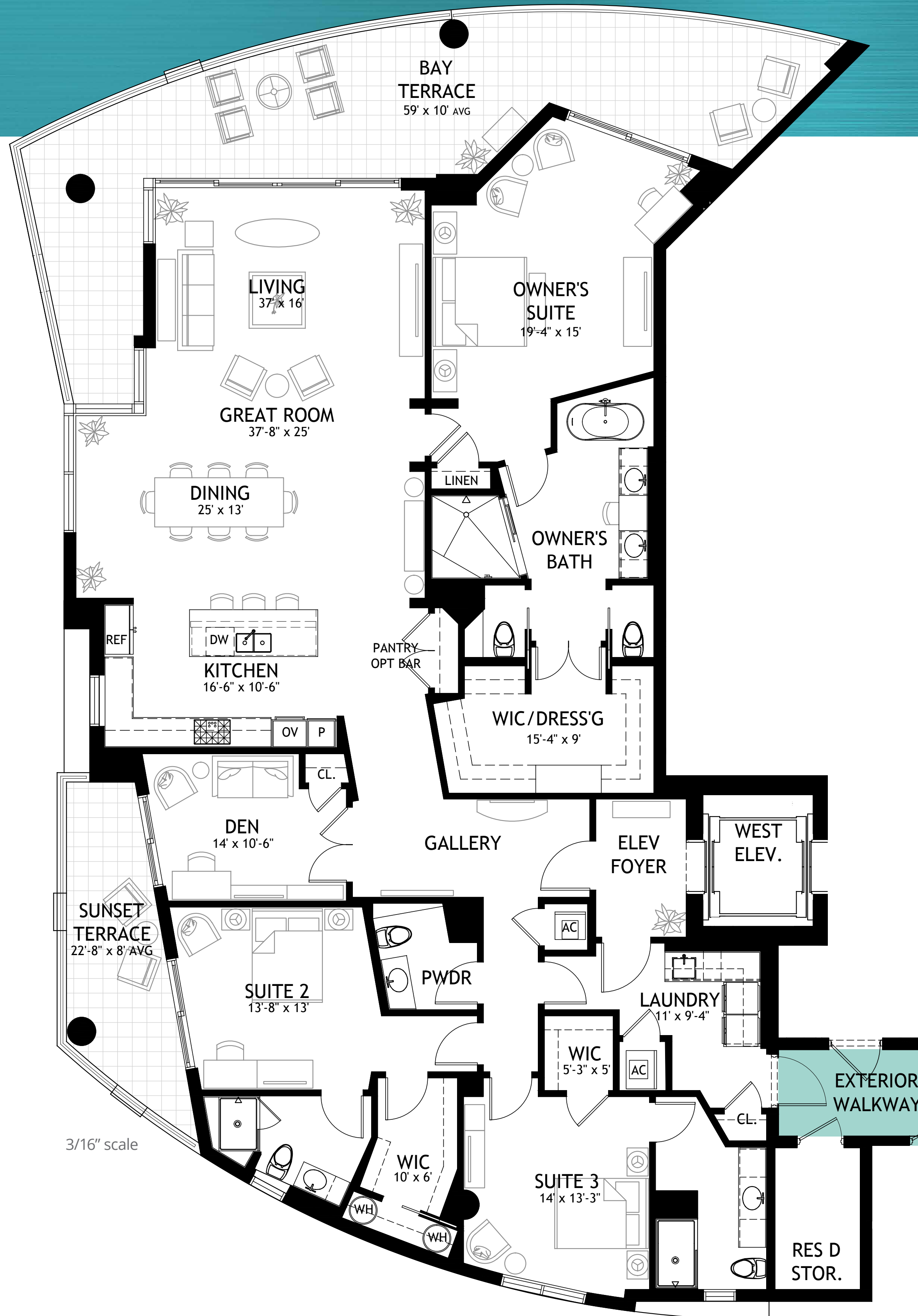

Virage proudly features Wolf and Sub-Zero appliances in all residences.

Sketches and illustrations are artist's renderings. Details and field variations are subject to changes. All dimensions are approximate and all floor plans and development plans are subject to change. Community features, amenities and pricing are approximate and subject to change without notice. Developer reserves the right to replace with items of equal value. There are various methods for calculating the total square footage of a condominium unit, and depending on the method of calculation, the quoted square footage of a condominium unit may vary by more than a nominal amount. The dimensions stated in this brochure are measured to the exterior boundaries of the exterior walls and the centerline of interior demising walls and, in fact, are larger than the dimensions of the "Unit" as defined in the Declaration of Condominium for Virage which is measured using interior measurements.



Virage

BAYSHORE

Sales Gallery Open Daily | 3401 Bayshore Boulevard, Tampa, FL 33629

813-336-3460 | www.VirageBayshore.com

ADG ASCENTIA
DEVELOPMENT GROUP

Smith &
Associates Real Estate

BCDC BATSON-COOK
DEVELOPMENT
COMPANY

Broker Participation is welcomed and encouraged.

ORAL REPRESENTATIONS CANNOT BE RELIED UPON AS CORRECTLY STATING REPRESENTATIONS OF THE DEVELOPER. FOR CORRECT REPRESENTATIONS, MAKE REFERENCE TO THIS BROCHURE AND TO THE DOCUMENTS REQUIRED BY SECTION 718.503, FLORIDA STATUTES, TO BE FURNISHED BY A DEVELOPER TO A BUYER OR LESSEE.



This project has been filed in the state of Florida and no other state. This is not an offer to sell or solicitation of offers to buy the condominium units in states where such offer or solicitation cannot be made. All rights reserved. Artist's renderings, dimensions, specifications, prices, availability and features are approximate and subject to change at any time without notice.